



SOLDAMATIC 

AUGMENTED TRAINING TECHNOLOGY FOR WELDING

Welding Training &
Performance Digitalization
Solution

2019

VALUE PROPOSITION

EDUCATION

Attract the new generation of young people to welding, train them better, safer, faster and reducing costs.



Metal Manufacturing Vocational Schools, technical universities.



Attract students
Improve safety
Spark future welders

FACTS & FIGURES

Thousands of units in
+50 countries
worldwide

+750
clients in
Education & Industry

+90.000
professionals
trained

WHAT IS SOLDAMATIC IE

Soldamatic IE is the first Welding Training Solution powered with Augmented Reality (AR) in the world.

Soldamatic IE is the third generation Soldamatic platform, it applies new technologies like AR to enhance the learning process and uses real welding equipment to develop skills and muscle memory.

It applies gamification to improve the motivation of trainees, personalized learning to adapt to their personal needs and green & safe technology to reduce the risks for newcomers and pollution.

ADVANCED

Bridge the gap with Industry, train in AR with competition multi-joints and different industry applications.



Welding Training Centres.



Improve efficiency
Reduce costs
Prepare for Industry & Welding Competitions



68%

average consumable savings



56%

real workshop time reduction



Increase the arc-on time by

3 to 5 times



34%

more certified trainees for IW than traditional methodology

INDUSTRY

Improve the productivity of the real welding operations on the field and reduce failure rate in industry recertification processes.



Industrial companies.



Improve productivity
Reduce % failure in recertification
Train better welding professionals



Educate

4 times more

students while keeping your existing lab infrastructure

**Real case study of a Soldamatic classroom in a Welding Centre*



The **AUGMENTED TRAINING** METHODOLOGY

Augmented Training proposes a new educational paradigm that promotes intensive practice, it is a dynamic and flexible model, which allows instructors to easily manage different courses with numerous students, regardless of their level of knowledge and/or learning pace.

Each student can join the training at any time, and only progresses once each stage has been satisfactorily completed, which allows them to set their own learning pace and guarantees a high level of qualification.



LICENSES

Start digitalizing your welding training programme with a flexible software subscription system today. Acquire your license yearly, for three years or lifetime.

HARDWARE +3 SOFTWARE SUBSCRIPTION OPTIONS	EDUCATION	ADVANCED	INDUSTRY
WELDING			
Specific Software for Education Welding Joints (EWJ)	<input checked="" type="checkbox"/>	<input type="checkbox"/>	<input type="checkbox"/>
5 Education Welding Joints	<input checked="" type="checkbox"/>	<input type="checkbox"/>	<input type="checkbox"/>
Specific Software for Advanced Welding Multijoints (AWM)	<input type="checkbox"/>	<input checked="" type="checkbox"/>	<input type="checkbox"/>
Specific Software for Industrial Welding Multijoints (IIWM)	<input type="checkbox"/>	<input type="checkbox"/>	<input checked="" type="checkbox"/>
Specific Software for TIC Pedal	<input type="checkbox"/>	<input checked="" type="checkbox"/>	<input type="checkbox"/>
Base Materials			
• Carbon Steel	<input checked="" type="checkbox"/>	<input type="checkbox"/>	<input type="checkbox"/>
• Stainless Steel	<input type="checkbox"/>	<input checked="" type="checkbox"/>	<input type="checkbox"/>
• Aluminium	<input type="checkbox"/>	<input checked="" type="checkbox"/>	<input type="checkbox"/>
Thicknesses			
• 3, 6 & 10 mm	<input checked="" type="checkbox"/>	<input type="checkbox"/>	<input type="checkbox"/>
• 2 & 15 mm	<input type="checkbox"/>	<input checked="" type="checkbox"/>	<input type="checkbox"/>
Processes			
• GTAW, GMAW, FCAW, SMAW	<input checked="" type="checkbox"/>	<input type="checkbox"/>	<input type="checkbox"/>
LEARNING			
Soldamatic eLearning	<input checked="" type="checkbox"/>	<input type="checkbox"/>	<input type="checkbox"/>
Augmented Training Methodology Course	<input checked="" type="checkbox"/>	<input type="checkbox"/>	<input type="checkbox"/>
Soldamatic Welding Curricula (Welding Initiation Course)	<input checked="" type="checkbox"/>	<input type="checkbox"/>	<input type="checkbox"/>
International Welder Program by IIW	<input type="checkbox"/>	<input checked="" type="checkbox"/>	<input type="checkbox"/>
Analysis Module	<input checked="" type="checkbox"/>	<input type="checkbox"/>	<input type="checkbox"/>
Advanced Analysis Module for Welding Multijoints	<input type="checkbox"/>	<input checked="" type="checkbox"/>	<input type="checkbox"/>
SERVICES			
Customer Area Access	<input checked="" type="checkbox"/>	<input type="checkbox"/>	<input type="checkbox"/>
Technical Support	<input checked="" type="checkbox"/>	<input type="checkbox"/>	<input type="checkbox"/>
Remote Assistance	<input checked="" type="checkbox"/>	<input type="checkbox"/>	<input type="checkbox"/>

HARDWARE

All the Soldamatic IE hardware components are real welding equipment. The shape of the Augmented Reality simulator and its front panel are inspired in real welding power sources.

- Soldamatic Welding Simulator
 - Augmented Reality Helmet
 - 2 WiFi antennas
-
- Torches
 - GMAW (MIG/MAG)
 - MMA Electrode
 - GTAW (TIG)
 - Electrode Stick
 - Filler rod
-
- Education Welding Joints
 - V-Butt
 - V-Butt 6" pipe
 - Overlapped
 - T-Angled
 - T-Angled 6" pipe to plate
-
- Optional:**
- Router (Only for classroom configurations)
 - Server (Only for classroom configurations)
 - Flight Case
 - Workstand
 - TIG Pedal

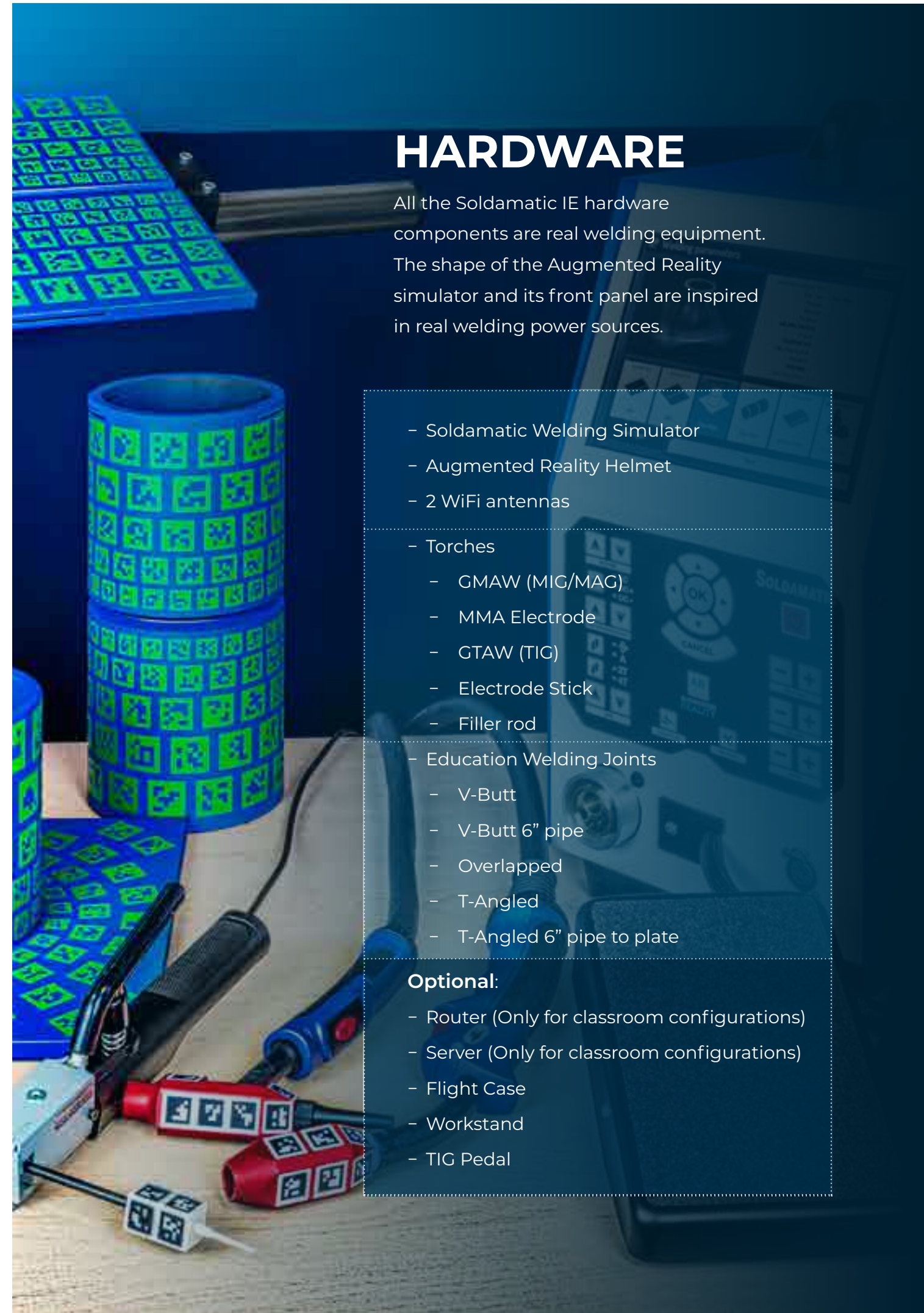

JOINTS



Education Welding Joint

The most used joints in welding training & certification worldwide.

- V-Butt Plate
- V-Butt 6" Plate
- Overlapped Plate
- T-Angled Plate
- T-Angled 6" Pipe to Plate

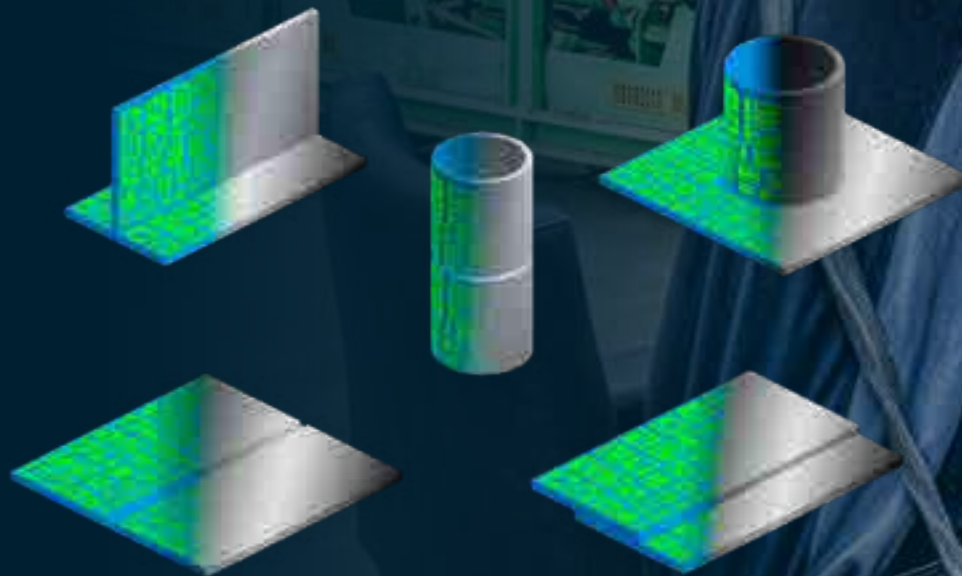

Advanced Welding Multijoint

Developed for International Welding Competition and different industries.

Different thicknesses, welding sequences and challenging positions in the same piece.

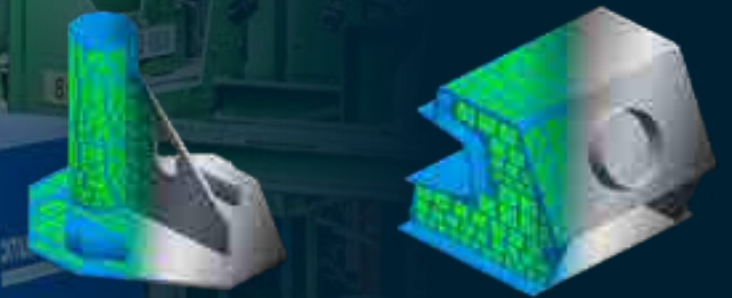

Industrial Welding Multijoint

Made to meet customer specific training and performance needs.

Bring your real pieces to Augmented Reality, train your welders with these augmented pieces and reduce costs and recertification failure.

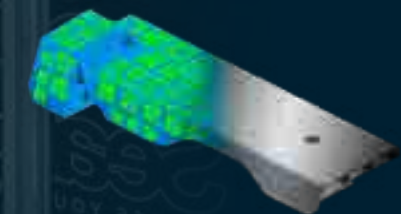

CONTENTS

High quality welding curricula developed by international experts to be performed with Soldamatic IE. These courses will allow instructors to teach welding according to the most demanded international standards and using the innovative Augmented Training methodology of Soldamatic.

The Advanced and Industry licenses include the International Welder program according to the Guideline IAB-089 from the European Welding Federation (EWF) and International Institute of Welding (IIW), designed to be taught with Soldamatic IE, and also suitable for the acquisition of the SENSE certificate from the American Welding Society (AWS).

Soldamatic IE contents include theory, tests and welding practices ready to be performed in different difficulty levels, with or without help icons.

Upload your own welding courses or take advantage of the digital training content specifically developed for Soldamatic IE.

Contents provided by:



**International
Welding
Experts**



SOLDAMATIC E-LEARNING

Learning Management application, focused on helping instructors to manage the whole training program, monitor and assess the trainees' performance and generate statistics and reports.





Seabery is an international company pioneering the development of Augmented Reality (AR) for professional training.

We are leading the market of Augmented Reality training solutions thanks to our large worldwide network of partners within industry, institutions and education.

SEABERYAT.COM

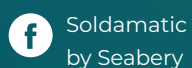

More info at
SOLDAMATIC.COM